



Water Control Systems

500HLR Series PRV

65-80mm

Application

Zurn Wilkins model 500HLR is designed for installation on potable water lines to reduce high inlet pressure to a lower outlet pressure. Body is drilled, tapped, and plugged to accept integral low flow by-pass kit (Model 20-NR3-500 - Reece code: 108581)

Engineering Specification

The high flow capacity makes this device most suitable for industrial water lines and commercial irrigation systems.

The direct acting integral by-pass design prevents buildup of excessive system pressure caused by thermal expansion.

The balanced piston design enables the regulator to react in a smooth and responsive manner to changes in system flow demand, while at the same time, providing protection from inlet pressure changes.

Standards Compliance

Australian Watermark



Materials

Main Valve Body	Cast Bronze
Bell Housing	Cast Bronze
Stem & Plunger	Cast Bronze
Elastomers	Buna Nitrile, EPDM
Polymers	Delrin™
Seat	Stainless Steel



Operating Parameters

Max. Working Water Pressure	2000kPa
Max. Working Water Temp	60°C
Reduced Pressure Range	70-875kPa
Factory Preset	500kPa
End Connections	Flanged AS 2129
Maximum Reduction	3:1

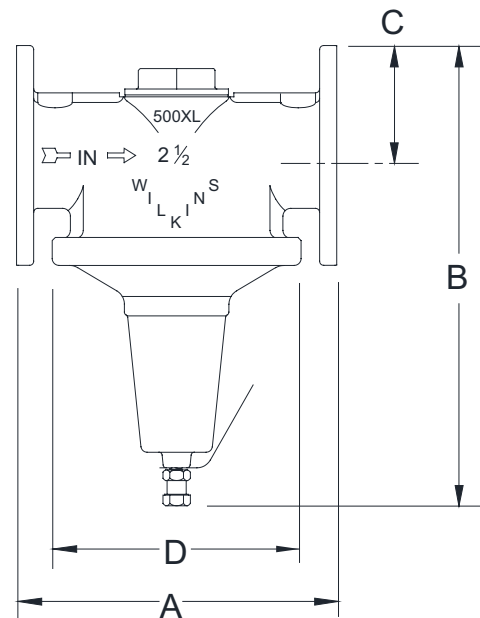

Dimensions & Weights (do not include pkg.)

MODEL SIZE mm	Flange Type	Reece Code	Zurn Code	DIMENSIONS (approximate)				WEIGHT kg
				A mm	B mm	C mm	D mm	
65	Table E	108617	212-500FCHLRBP-BS10	263	381	89	203	13.5
80	Table E	108618	3-500FCHLRBP-BS10	279	451	95	203	22.5

Zurn Industries, LLC | Wilkins
1747 Commerce Way, Paso Robles, CA U.S.A. 93446 Ph. 855-663-9876, Fax 805-238-5766

In Australia | Reece Group
57 Balmain Street, Cremorne VIC Australia 3121, Ph. 1800 080 055

zurn.com.au | reece.com.au

Rev. B
Date: 9/24
Document No. REG-PRV500

Flow Characteristics

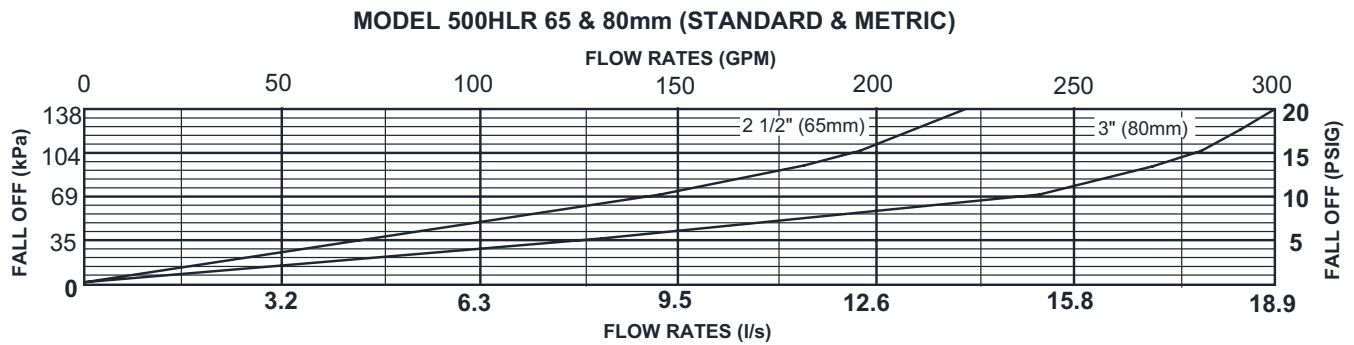

Typical Installation

Local codes shall govern installation requirements. Unless otherwise specified, the assembly shall be installed in accordance with the manufacturer's instructions and the latest edition of the Plumbing Code of Australia and/or AS/NZS 3500. The assembly shall be installed with sufficient side clearance for testing and maintenance. The Model 500HLR may be installed in any position. Multiple installations are recommended for wide demand variations or where the desired pressure reduction is more than 3 to 1 (i.e.: 1050kPa inlet reduced to 350kPa outlet).

Caution: Anytime a reducing valve is installed or adjusted, a pressure gauge must be used downstream to verify correct pressure setting. Do not bottom adjustment bolt on bell housing.

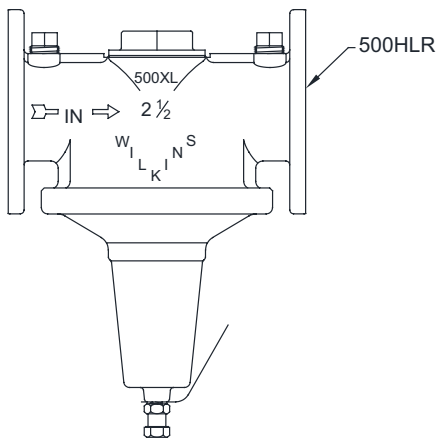
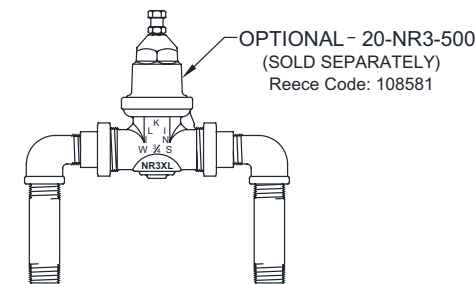

PARALLEL INSTALLATION

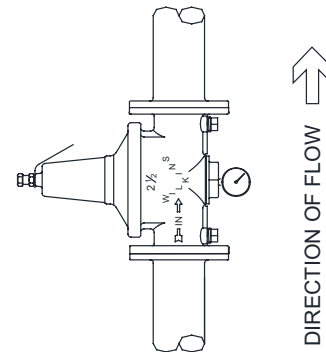

VERTICAL INSTALLATION

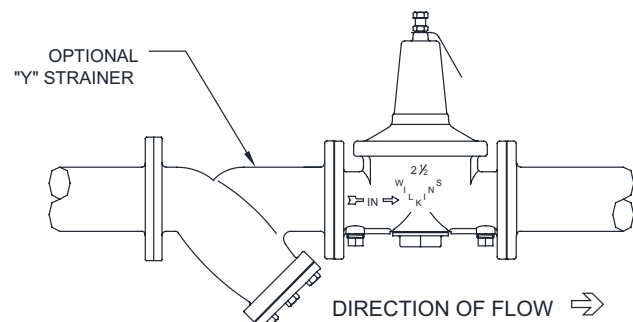

HORIZONTAL INSTALLATION

Specifications

The Pressure Reducing Valve shall be Australian Watermark certified (AS 1357.2). Consist of a low lead bronze body and bronze bell housing, shall have an access cover for the plunger and shall have a bolt to adjust the downstream pressure between a range of 70 and 875kPa. The Pressure Reducing Valve shall be of the balanced piston design and shall reduce pressure in both flow and no-flow conditions. The bronze bell housing and access caps shall be threaded to the body and shall not require the use of ferrous screws. The Pressure Reducing Valve shall be a ZURN Model 500HLR.