

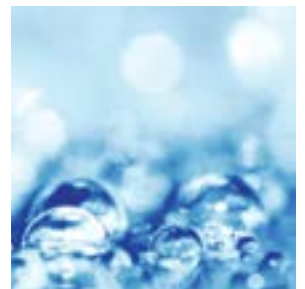

304 STAINLESS STEEL

Product Guide



ZURN.COM.AU

CONTENTS

TROUGHS	2
BABY BATH	5
CLEANERS BASIN	6
LAUNDRY BASIN	7
BASINS	8
CISTERNS	16
TOILET PANS	18
URINALS	22
TUNDISHES	26
PLASTER/SOLIDS TRAP	28
WINE SPITTOON	29



49 LAKESIDE DRIVE BROADMEADOWS VIC 3047
1300 00 ZURN
salesaus@zurn.com
zurn.com.au

PWD TROUGH



The 304 Precision PWD (Public Works Department) trough is manufactured to the highest quality using 1.2mm #304 Stainless Steel, with fully welded and radius corners. The PWD pattern trough is ideal for use as a drinking trough or for hand washing. Designed for use in schools, child care centres, sporting clubs and public areas.

FEATURES:

- > Fully welded
- > 25mm radius corners for safety and ease of cleaning
- > Brackets included
- > 50mm plug & waste included
- > 40mm deep splashback to accommodate plumbing
- > Satin Finish

AVAILABLE SIZES:

- > 900mm, 1200mm 1500mm, 1800mm, 2100mm and 2400mm
- > Both left and right hand outlet available

OPTIONS:

- > Available with plumbing and taps installed (see tapware section for selection)
- > Tap holes cut to your requirements (fee applies)

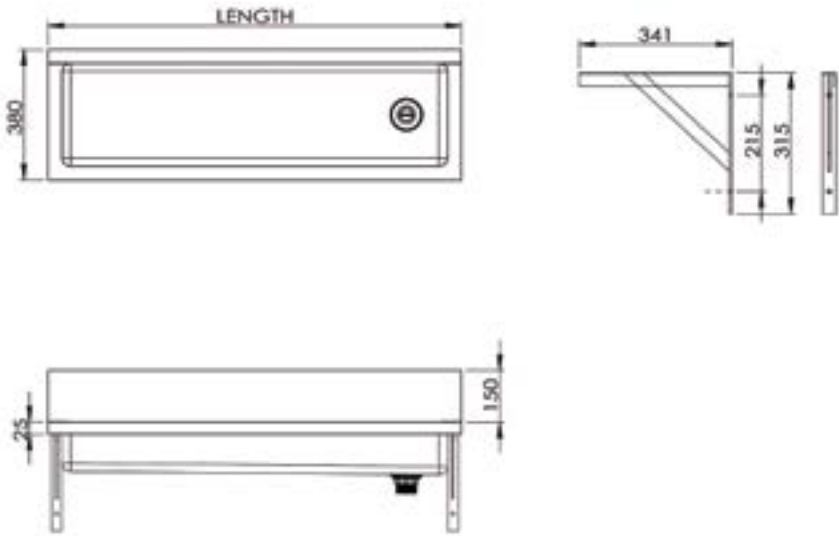

HOB MOUNT TROUGH

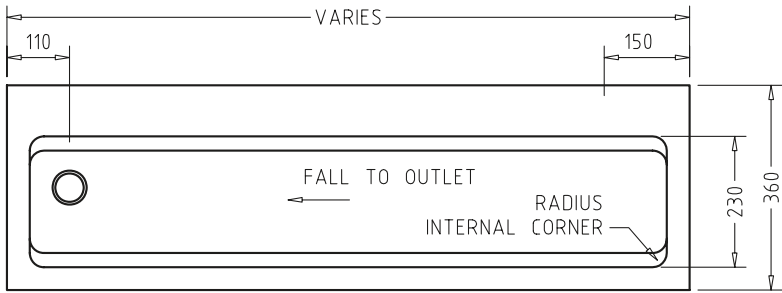

TOP VIEW

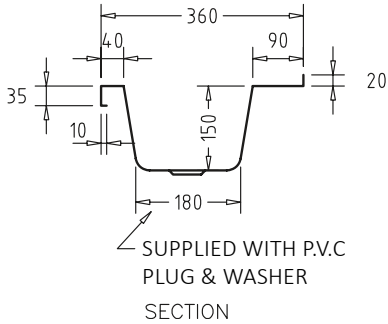

SECTION

The hob mount trough is manufactured to the highest quality using 1.2mm #304 Stainless Steel, with fully welded and internal radius corners. They are ideal for use in schools, child care centres, sporting clubs and public areas.

FEATURES:

- > Fully fabricated construction
- > Internal radius corners
- > PVC 50mm plug & waste included
- > Large rear tap landing
- > Brackets included

AVAILABLE SIZES:

- > 900mm, 1200mm 1500mm, 1800mm, 2100mm and 2400mm
- > Both left and right hand outlet available

INSET ART BASIN

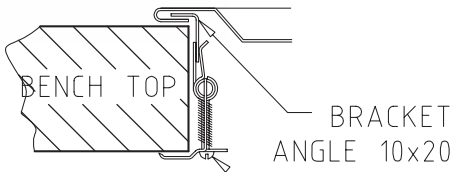
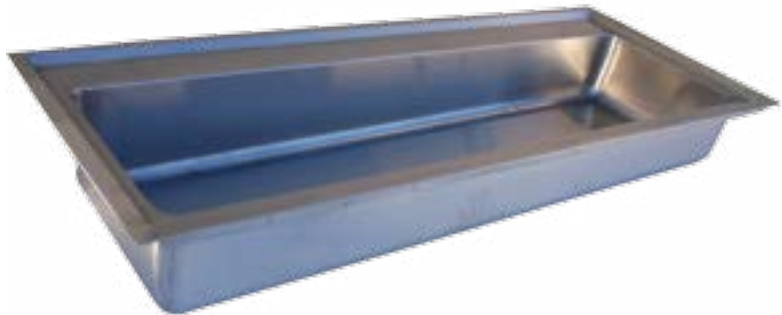

The Inset Art Basin is manufactured to the highest quality using using 1.2mm #304 Stainless Steel, with Inset bench mount design and fully internal radius corners. Custom-made lengths for tailored use in art school facilities.

FEATURES:

- > Fully fabricated construction
- > Internal radius corners
- > PVC 50mm plug & waste included
- > Rear tap landing
- > Made to order

PRODUCTS:

- > ARTINST-(SIZE)(LH/RH) - Inset Art Basin
- > ARTS-(SIZE)(LH/RH) - Mounted Inset Art Basin

AVAILABLE SIZES:

- > 900mm, 1200mm 1500mm, 1800mm, 2100mm, 2400mm and 3000mm
- > Both left and right hand outlet available

PLEASE NOTE: Custom-made products are non-refundable

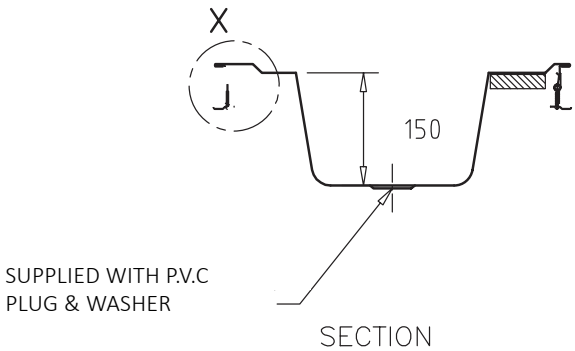

BABY BATH

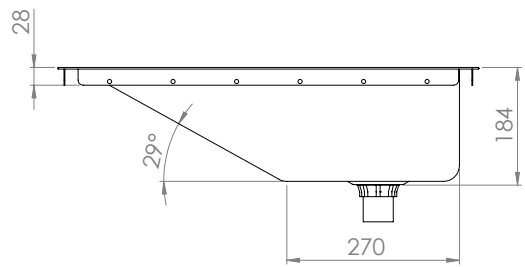
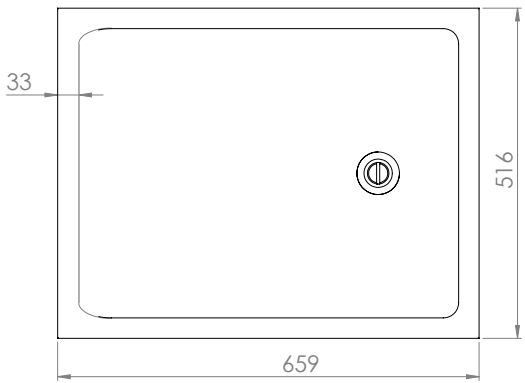

The 304 Precision Baby Bath is a stylish and seamless design. Manufactured from high quality 1.2mm #304 Stainless Steel. This Baby Bath is designed to be inset into a bench top. They are ideal for use in hospitals, day care centres, public facilities and caravan parks.

FEATURES:

- > Fully welded seamless design
- > Clips and 50mm plug & waste included

CLEANERS BASIN



CLEANER BASIN WITH LEG KIT
PRODUCT CODE 304P-CLE-LEG-COM

The 304 Precision heavy duty Cleaners Basin is constructed from quality #304 Stainless Steel. It is fully welded and has 25mm radius internal corners. The external corners are at a 45° angle for added safety. This basin is designed for heavy day to day use. It comes complete with a heavy duty hinged grate to hold even the heaviest cleaning buckets. Ideal for hospitals, schools and anywhere janitorial duties are performed regularly.

FEATURES:

- > Heavy #304 Stainless construction
- > 25mm radius corners for safety and ease of cleaning
- > Complete with heavy duty hinged grate and brackets
- > 50mm plug & waste included
- > Leg kits available with Basin (304P-CLE-LEG-COM)
- > 45 litre bowl capacity

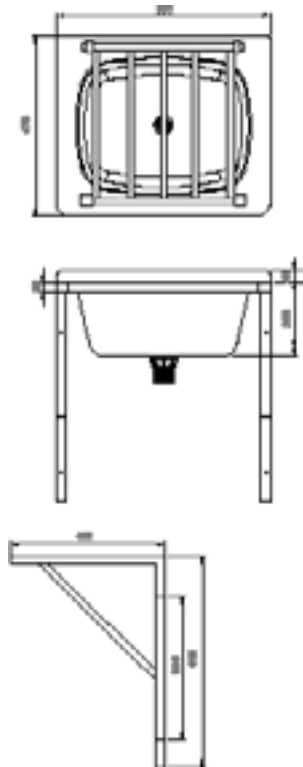

WALL MOUNT LAUNDRY TUB

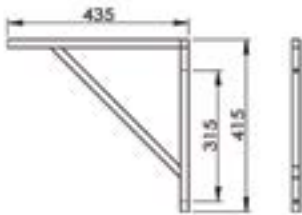
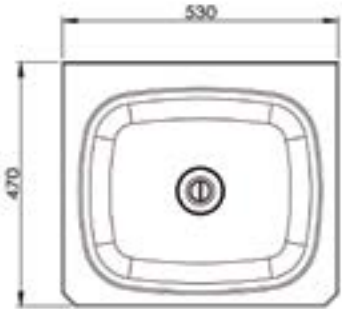

The 304 Precision Wall Hung Laundry Tub is manufactured using quality #304 Stainless Steel. This heavy duty laundry tub is manufactured to the highest quality, being fully welded and having 25mm radius internal corners. The external corners are at a 45° angle for added safety. Holding 45 litres, this laundry tub will suit all commercial applications and residential.

FEATURES:

- > Heavy #304 Stainless construction
- > Fully welded
- > 25mm radius corners for safety and ease of cleaning
- > 45 litre bowl capacity

BASIN - 500 X 400



The 304 Precision range of 500 x 400 Basins are made from quality #304 Stainless Steel. These wall basins are extremely robust and hard wearing. This range complies with local authority food preparation requirements. Perfectly suited for schools, portable buildings, temporary building sites and factories.

*Wall Basin comes with double safety fold on bottom edge.

FEATURES:

- > 0, 1, 2, and 3 tap hole configurations
- > 11.5 litre bowl capacity
- > 40mm plug & waste and wall brackets included

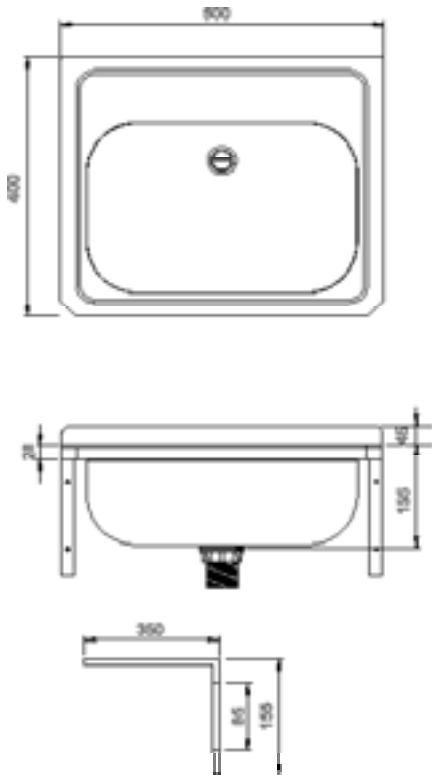

SOAP DISH BASIN - 500 X 400

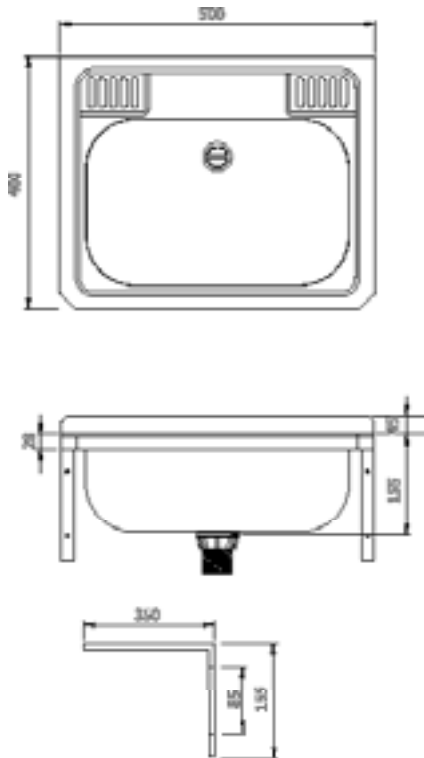

The 304 Precision range of 500 x 400 Basins are made from quality #304 Stainless Steel. These wall basins are extremely robust and hard wearing. This range complies with local authority food preparation requirements. Perfectly suited for schools, portable buildings, temporary building sites and factories.

* Wall Basin comes with double safety fold on bottom edge.

FEATURES:

- > 0, 1, 2, and 3 tap hole configurations
- > 11.5 litre bowl capacity
- > Added feature - soap dishes
- > 40mm plug & waste and wall brackets included

WALL BASIN- 400 X 215



The 304 Precision 400 x 215 Wall Basin is made from quality #304 Stainless Steel. This basin is extremely robust and hard wearing. Perfectly suited for schools, portable buildings, temporary building sites and factories.

FEATURES:

- > 0TH, LH and RH configurations
- > 40mm plug & waste and appropriate fixings included

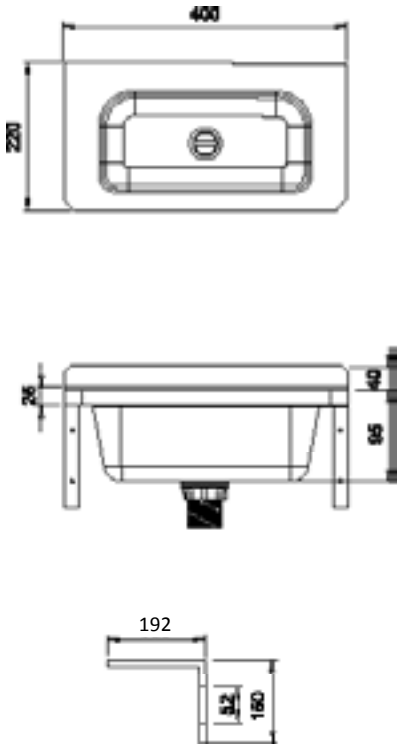

WALL BASIN KNEE OPERATED

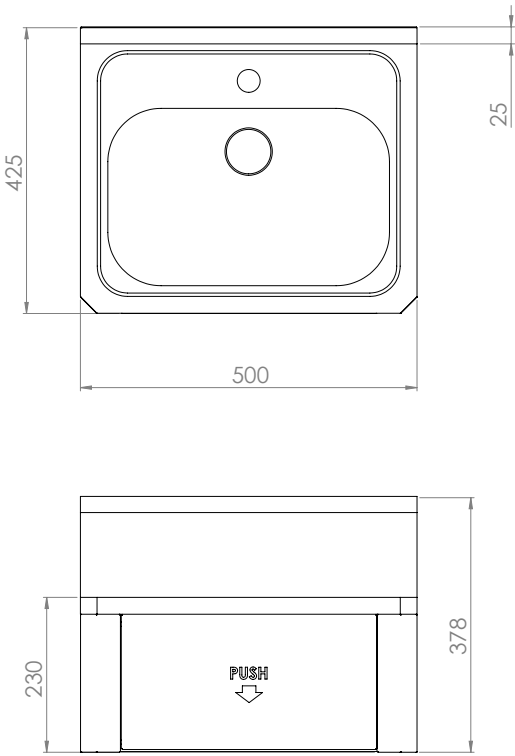

The 304 Precision Wall Basin Knee Operated is the perfect all in one solution for your hands free needs. This 500 x 400 fully shrouded wall basin comes complete with a timed flow mechanism, gooseneck outlet and all associated plumbing.

Suitable for applications where hands free is the only option like abattoirs and food preparation areas.

FEATURES:

- > Timed flow
- > 150-350kPa inlet water pressure
- > 0 – 60° water temperature
- > WELS – 5 Star – 6L
- > Watermark Approved - WM-022452

HAND WASH BASINS



PRODUCT CODE 304P-RFB



PRODUCT CODE 304P-CORNER



PRODUCT CODE 304P-RDSFWB

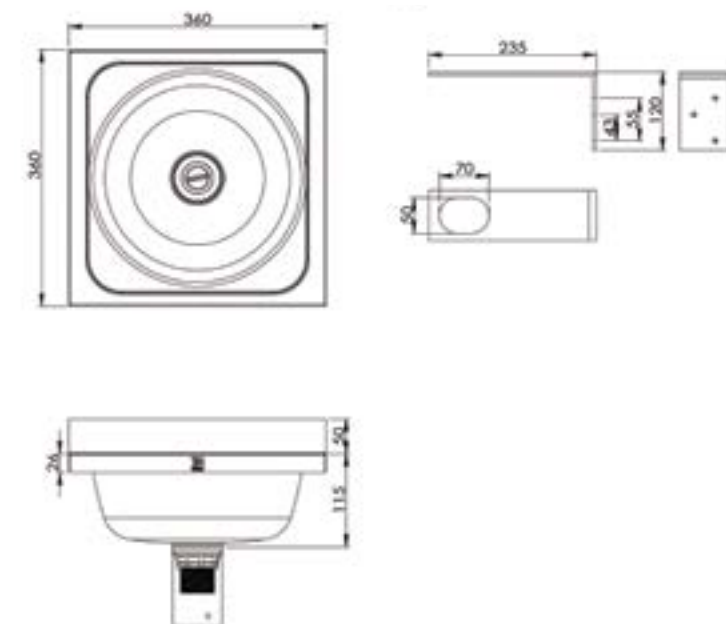
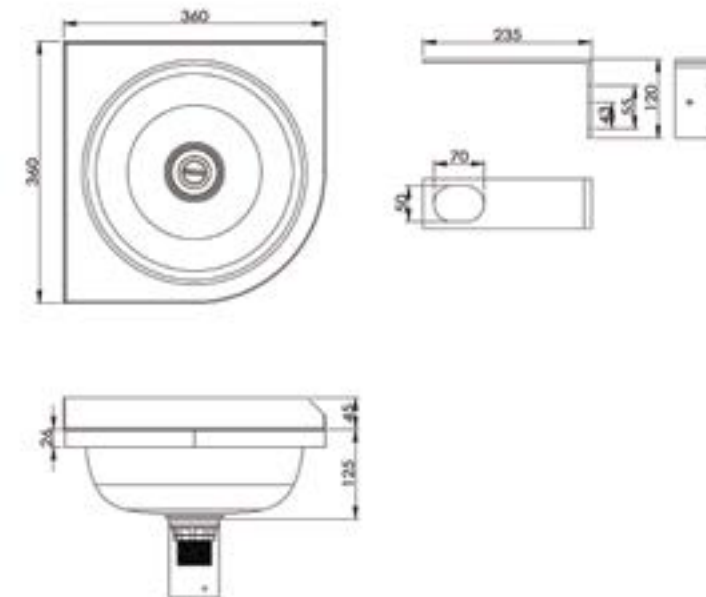
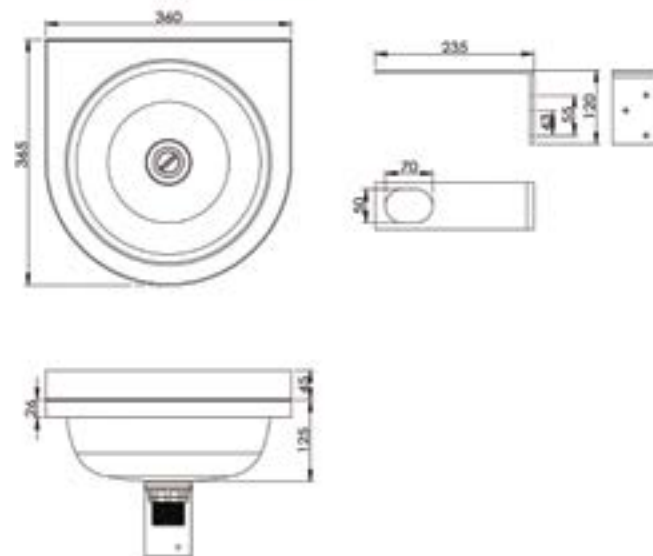

This range of 304 Precision is made from high quality #304 Stainless Steel. With their stylish design these basins will suit just about any installation. Perfect for clubs, pubs, schools and building sites.

FEATURES:

- > Stylish design
- > Robust wall bracket and 40mm plug & waste included
- > Pre-plumbed options available

INSET BASIN - 500 X 400



The 304 Precision 500 x 400 Inset Basin is made from quality #304 Stainless Steel. This basin is extremely robust and hard wearing. This range complies with local authority food preparation requirements. Perfectly suited for schools, portable buildings, temporary building sites and factories.

FEATURES:

- > 0, 1, 2, and 3 tap hole configurations
- > 11 litre bowl capacity
- > 40mm plug & waste and appropriate fixings included

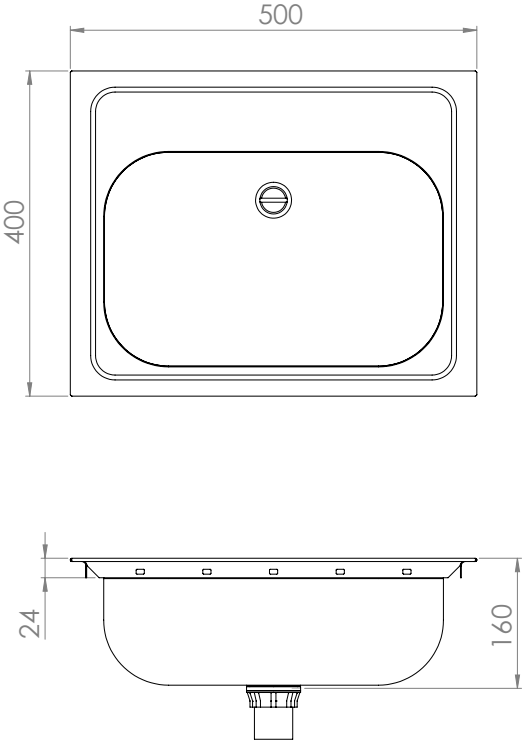

INSET BASIN - 410 X 380



The 304 Precision 410 x 380 Inset Basin is made from quality #304 Stainless Steel. This basin is extremely robust and hard wearing. With it's compact size and large bowl capacity this inset basin could be the solution if space is limited. Perfectly suited for schools, portable buildings, temporary building sites and factories.

FEATURES:

- > 0TH and 1TH configurations
- > 40mm plug & waste and appropriate fixings included

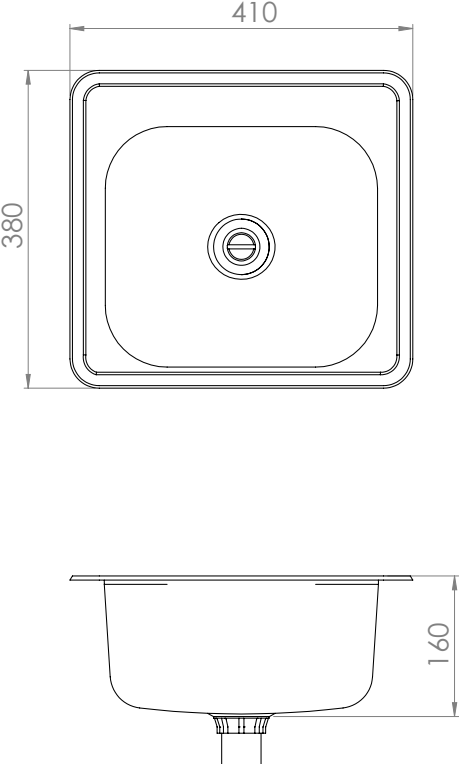

CISTERN W/ PULL CHAIN



The 304 Precision Cisterns with Pull Chains are designed for the harshest environments and installations. Constructed with 1.2mm high quality #304 Stainless Steel. These cisterns are suitable for prisons, holding cells, institutional facilities, public areas and heavy vandal prone areas.

FEATURES:

- > For use with urinals (304P-WHU)
- > Single Flush Volume 1.4L
- > Pull Chain Included
- > 50mm Outlet standard
- > WELS – 3 Star – 1.4L
- > Watermark Approved - WM-022622

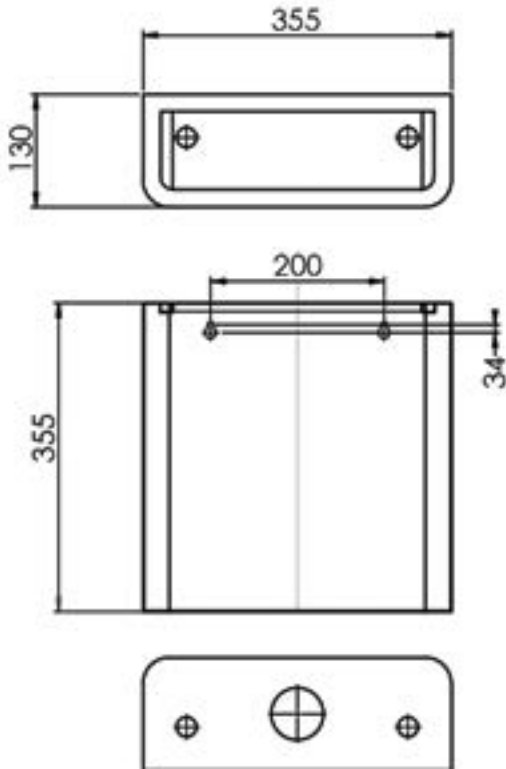

CISTERN W/ DUAL FLUSH BUTTONS



The 304 Precision Cisterns with Dual Flush Buttons are designed for the harshest environments and installations. Constructed with 1.2mm high quality #304 Stainless Steel. These cisterns are suitable for prisons, holding cells, institutional facilities, public areas and heavy vandal prone areas.

FEATURES:

- > For use with toilet pans (304P-PP)
- > Flush Volume 4.5 / 3L
- > Dual Flush Buttons Included
- > 50mm Outlet standard
- > WELS – 5 Star – 4.5 / 3L
- > Watermark Approved - WM-022452

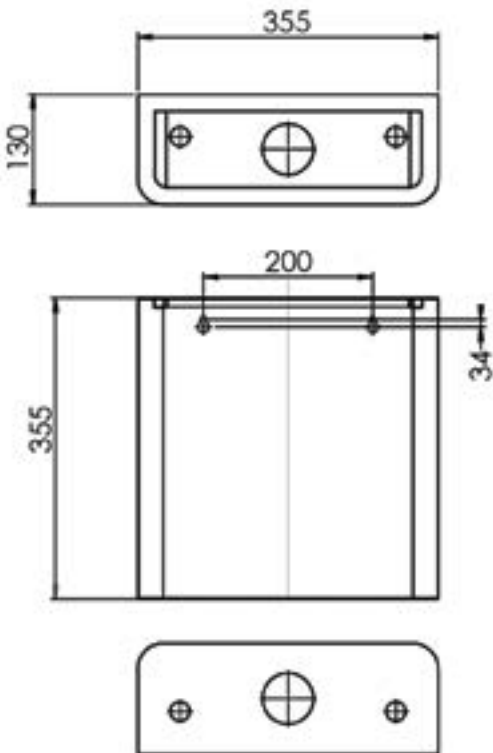

WALL FACED TOILET PAN

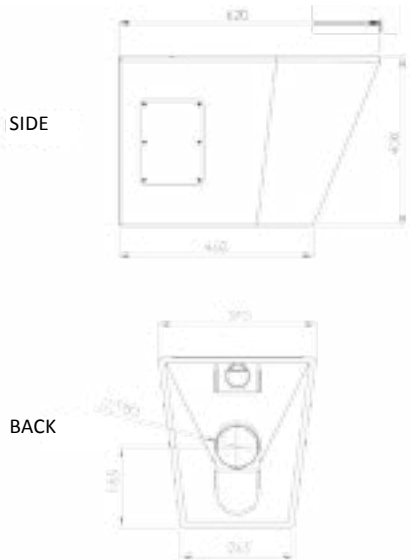

PRODUCT CODE 304P-WFP-P

The 304 Precision Wall Faced Toilet Pans are designed for the harshest environments and installations. The pans are fully welded with radius edges for added safety. Made from high quality heavy duty #304 Stainless Steel. Fully ligature resistant these pans are suitable for prisons, holding cells, institutional facilities and heavy vandal prone areas.

FEATURES:

- > Efficient bowl design – 6 / 3L
- > Concealed fixings
- > Access panels on both sides of pan
- > Vandal resistant
- > Ligature proof
- > WELS – 3 Star – 6 / 3L

OPTIONS:

- > LWG-JSTS - vandal resistant toilet seat

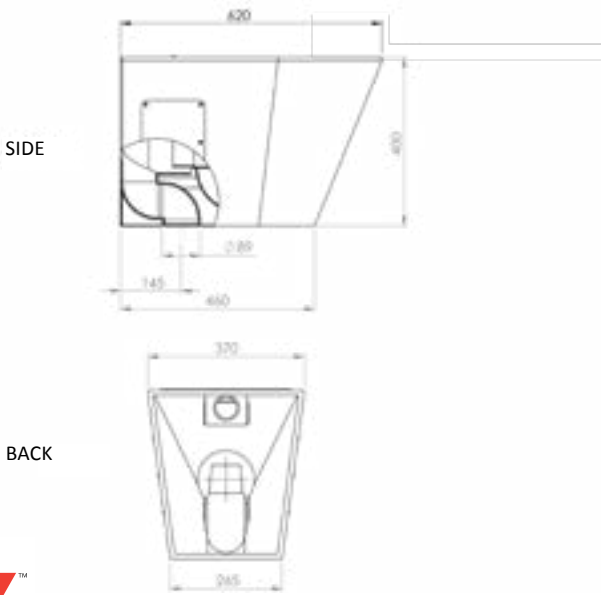
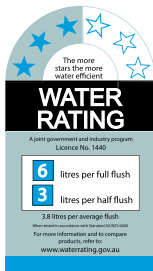

PRODUCT CODE 304P-WFP-S

DISABLED WALL FACED TOILET PAN

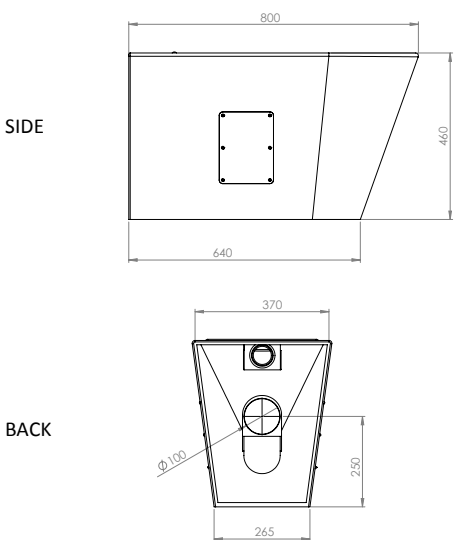

PRODUCT CODE 304P-WFPD-P

The 304 Precision Disabled Wall Faced Toilet Pans are designed for the harshest environments and installations. The pans are fully welded with radius edges for added safety. Made from high quality heavy duty #304 Stainless Steel. Fully ligature resistant these pans are suitable for prisons, holding cells, institutional facilities and heavy vandal prone areas.

FEATURES:

- > Efficient bowl design – 6 / 3L
- > Concealed fixings
- > Access panels on both sides of pan
- > Vandal resistant
- > Ligature proof
- > WELS – 3 Star – 6 / 3L
- > Watermark Approved - WM-022452

OPTIONS:

- LWG-JSTS - vandal resistant toilet seat

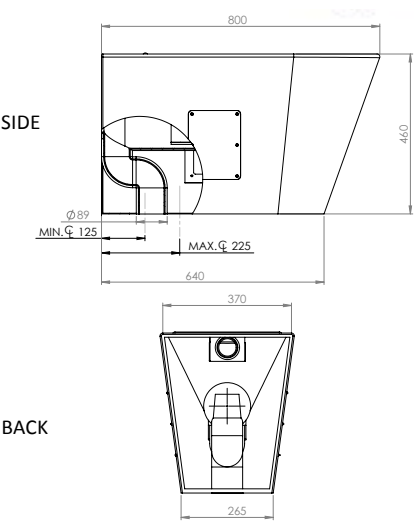
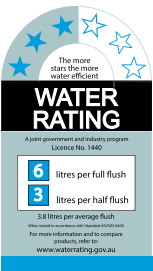

PRODUCT CODE 304P-WFPD-S

COMBINATION PAN W/ PEDESTAL BASIN

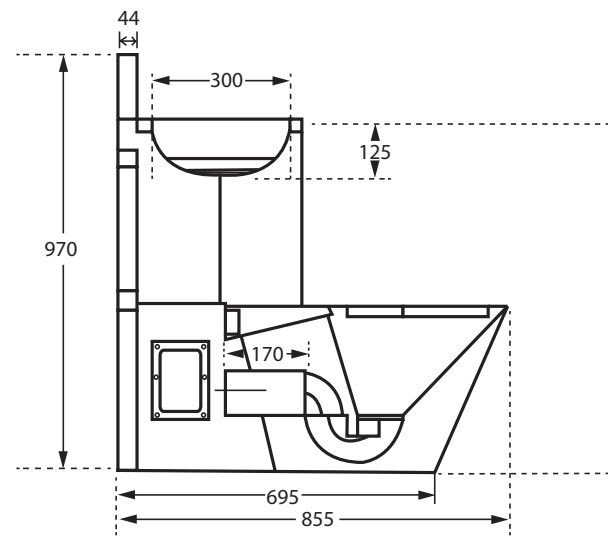

The 304 Precision Combination Toilet Pans with Pedestal Basin are designed for the harshest environments and installations. Made from high quality heavy duty #304 Stainless Steel. The combination is seamlessly welded and fully ligature resistant. Suitable for prisons, holding cells, institutional facilities and heavy vandalism areas.

FEATURES:

- > Concealed fixings
- > Access panels on both sides of pan
- > Vandal resistant
- > Ligature proof
- > WELS – 3 Star – 6 / 3L
- > Watermark Approved - WM-022452

OPTIONS:

LWG-JSTS - vandal resistant toilet seat

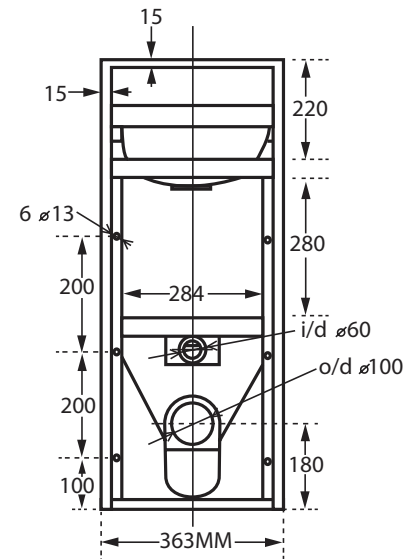
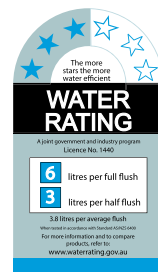

PEDESTAL TOILET PAN

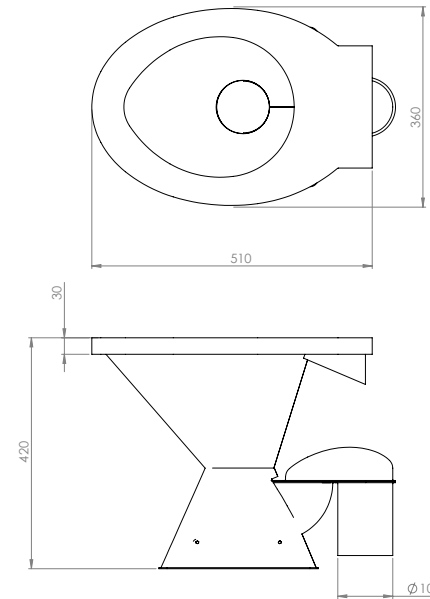

PRODUCT CODE 304P-PP-S

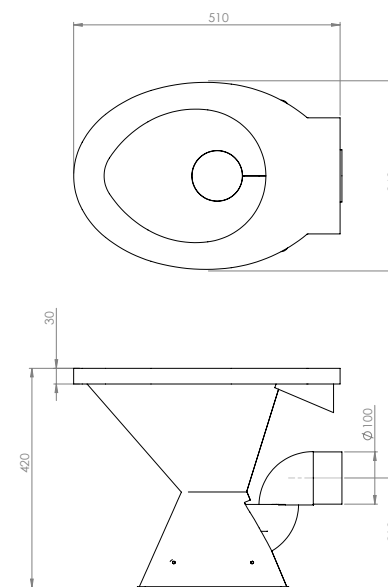

PRODUCT CODE 304P-PP-P

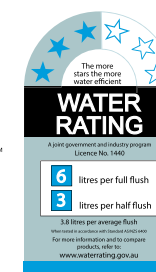

The 304 Precision S/S Pedestal Toilet Pan is suitable for all installations. Specially designed for high use, vandal prone areas and retrofitting of vitreous china pans. These pans are ideally suited to schools, nightclubs, institutional facilities and sports clubs.

FEATURES:

- > Efficient bowl design – 6 / 3L
- > Concealed fixings
- > Easy cleaning
- > Vandal resistant
- > WELS – 3 Star – 6 / 3L
- > Watermark Approved - WM-022452

OPTIONS:

LWG-JSTS - vandal resistant toilet seat

URINETTE



The 304 Precision Urinettes are made from high quality heavy duty #304 Stainless Steel. Innovative, lightweight design and unique flushing spreader. They are ideal for use in hospitals, day care centres, public facilities and caravan parks.

FEATURES:

- > Efficient bowl design – 0.7L
- > Concealed fixings
- > Easy cleaning
- > Top or back entry
- > WELS – 3 Star – 0.7L
- > Watermark Approved - WM-022125

OPTIONS:

- 304P-URIN-TE - Top entry urINETTE
- 304P-URIN-BE - Back entry urINETTE

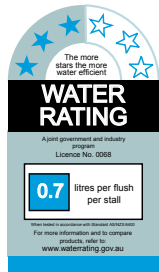
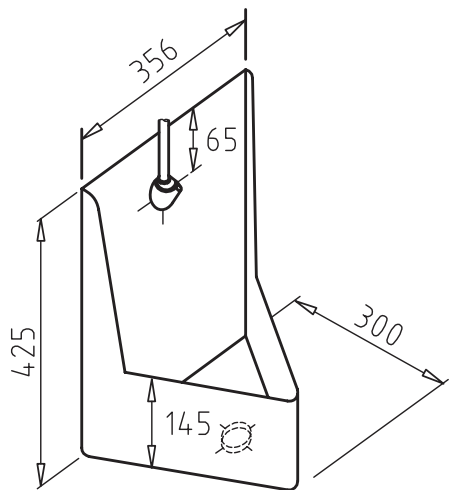

WALL HUNG URINAL



The 304 Precision S/S Wall Hung Urinals are designed for the toughest conditions. Using high quality 1.2mm #304 Stainless Steel. They feature a unique boxed sparge for superior flushing. These Urinals are a cost effective option for any installation and are ideally suited to portable buildings, public areas and factories.

FEATURES:

- > Fully welded
- > Radius corners for ease of cleaning and safety
- > Superior sparge design for ultra low water consumption
- > ‘Z’ strip mounting system for easy installation
- > Centre Outlet
- > All Urinals come with 50mm Domed outlet and 40mm S/S Flushpipe
- > WELS – 3 Star – 1.4L
- > Watermark Approved - WM-022452

AVAILABLE SIZES (MM):

600, 900, 1200, 1500, 1800, 2100 and 2400

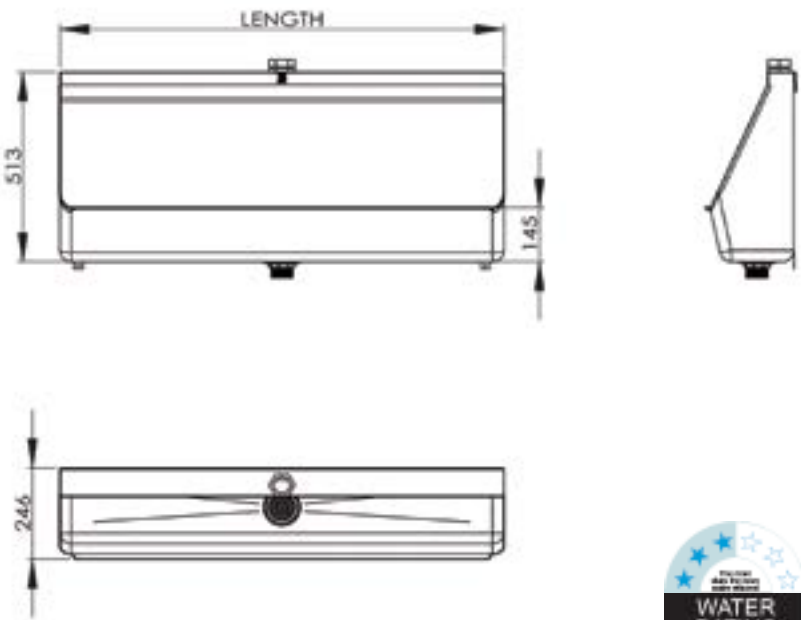

FLOOR MOUNT URINAL



The Floor Mount Urinals are made from high quality heavy duty #304 Stainless Steel. Concealed vandal resistant sparge with unique water distribution butterfly concealed. They are ideally suited to portable buildings, public areas and factories.

FEATURES:

- > Full face flushing features
- > Custom-made option
- > Solid round rod grates
- > Left, right or centre outlet
- > Top or back inlet
- > WELS – 4 Star – 1.1L
- > Watermark Approved - WM-021160

AVAILABLE SIZES (MM):

- > 600, 900, 1200, 1500, 1800, 2100, 2400, 2700 and 3000
- > Custom-made sizes available

OPTIONS:

- > 50, 65, 100 outlets available

PLEASE NOTE: Custom-made products are non-refundable

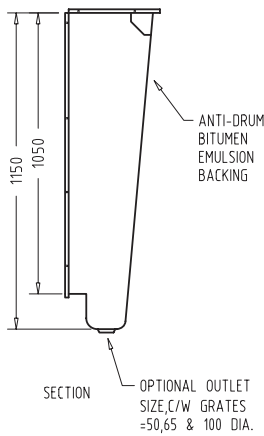
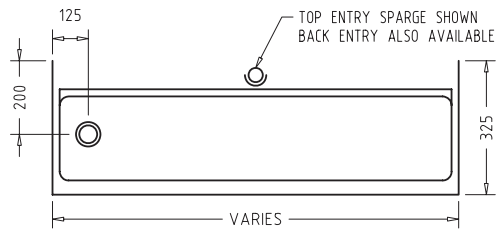

TREAD MOUNT URINAL



The Tread Mount Urinals are made from high quality heavy duty #304 Stainless Steel. Concealed vandal resistant sparge with unique water distribution butterfly concealed. They are ideally suited to portable buildings, public areas and factories.

FEATURES:

- > Full face flushing features
- > Custom-made option
- > Solid round rod grates
- > Left, right or centre outlet
- > Top or back inlet
- > WELS – 4 Star – 1.1L
- > Watermark Approved - WM-021160

AVAILABLE SIZES (MM):

- > 600, 900, 1200, 1500, 1800, 2100, 2400, 2700 and 3000
- > Custom-made sizes available

OPTIONS:

- > 50, 65, 100 outlets available

PLEASE NOTE: Custom-made products are non-refundable

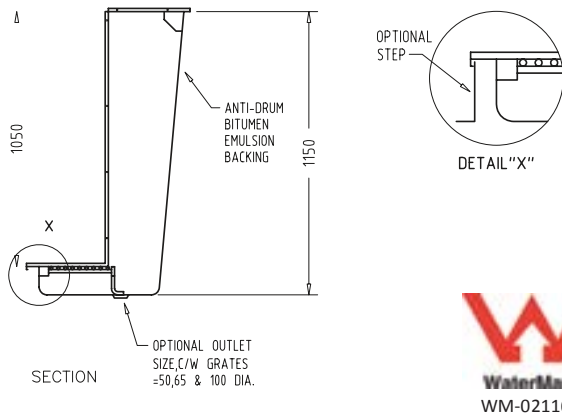
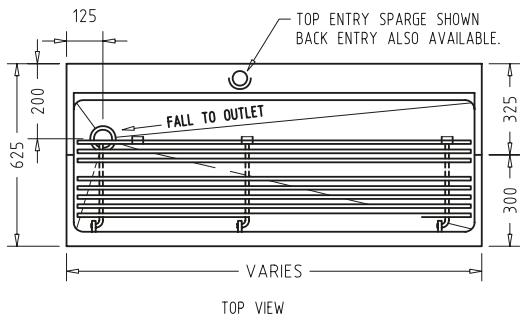

TUNDISHES

The range of tundishes are all made from top of the range #304 Stainless Steel. Many options are available to suit your needs. All Tundishes come standard with a 40mm BSP threaded outlet for easy connection directly to a trap. Tundishes are commonly used in apartment buildings, hospitals and aged care facilities.



TUNDISH-SF



TUNDISH-PF



LWG-GPO-TUN



TUNDISH-VSH

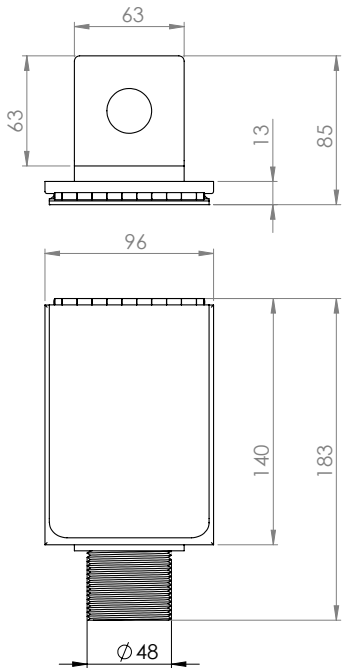
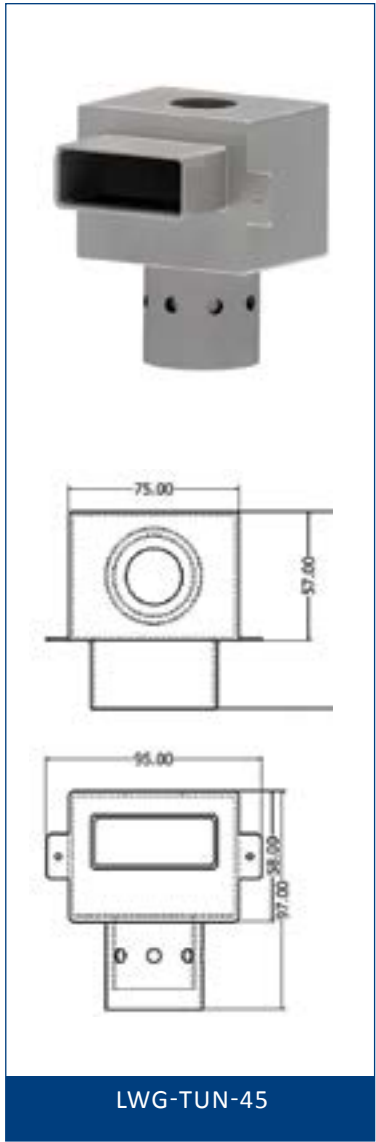
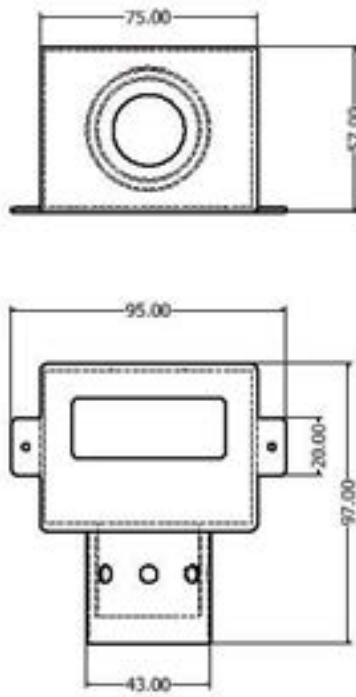
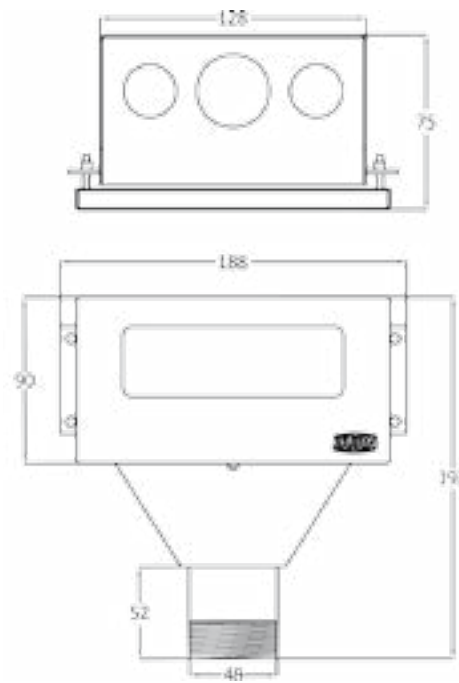
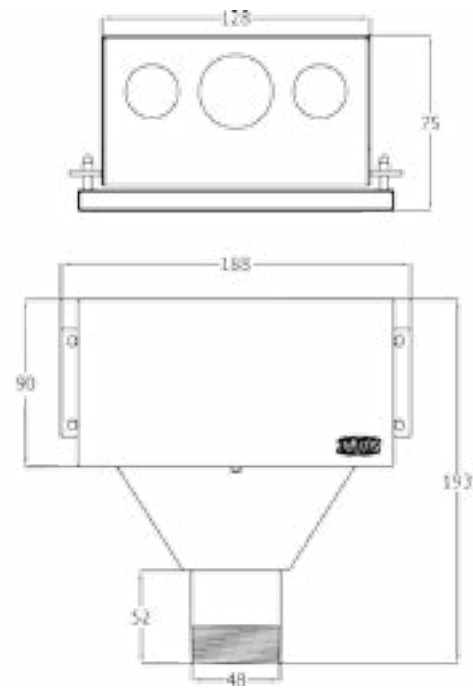

PLASTER/SOLIDS TRAP



The Plaster/Solids Traps are made from high quality #316 Stainless Steel. Designed specifically for the health industry and ideal use for anywhere plaster is used and entrapment of solids is required.

FEATURES:

- > Fully fabricated construction
- > #316 grade Stainless Steel
- > 35L capacity
- > Removable split lids

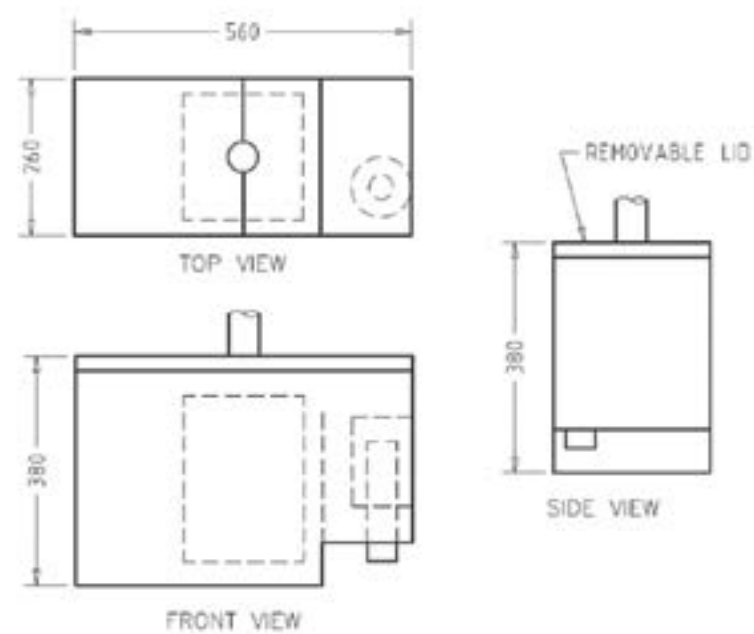

49 LAKESIDE DRIVE BROADMEADOWS VIC 3047
 1300 00 ZURN
salesaus@zurn.com
zurn.com.au



ZURN AUSTRALIA

ABN: 12 164 922 758



PHONE | 1300 00 ZURN

EMAIL | salesaus@zurn.com

HEAD OFFICE | VICTORIA
49 Lakeside Drive
Broadmeadows VIC 3047
Fax: +61 3 9357 1455

QUEENSLAND
3 / 11 Breene Place
Morningside QLD 4170
Fax: +61 7 3396 7066

NEW SOUTH WALES
Unit 6 / 3-11 Hallmark Street
Pendle Hill NSW 2145
Fax: +61 2 9631 2065

WESTERN AUSTRALIA
398 Victoria Road
Malaga WA 6090
Fax: +61 8 9249 8922